



73 Stoborough Crescent, Featherstone, WF7 5FA

Located in the charming area of Stoborough Crescent, Featherstone, this delightful three-bedroom semi-detached house is an excellent opportunity for first-time buyers and families alike. Built in 2016, this modern new build offers a generous living space of 840 square feet, designed with contemporary living in mind.

Upon entering, you will find a welcoming reception room that provides a perfect setting for relaxation and entertaining. The property boasts three well-proportioned bedrooms, ensuring ample space for family members or guests. The convenience of a downstairs WC adds to the practicality of this home, making daily life that little bit easier.

One of the standout features of this property is the private rear garden, which offers a tranquil outdoor space for children to play, gardening enthusiasts to indulge their passion, or simply for enjoying a peaceful afternoon in the sun.

Situated close to local amenities and transport links, this home provides easy access to essential services and commuting options, making it an ideal choice for those who value convenience.

- 3 Bed Semi-detached
- Perfect for First time buyers or Families
- Private rear garden
- Off road parking for 2 vehicles
- Close to local amenities and transport links
- Downstairs WC

£215,000

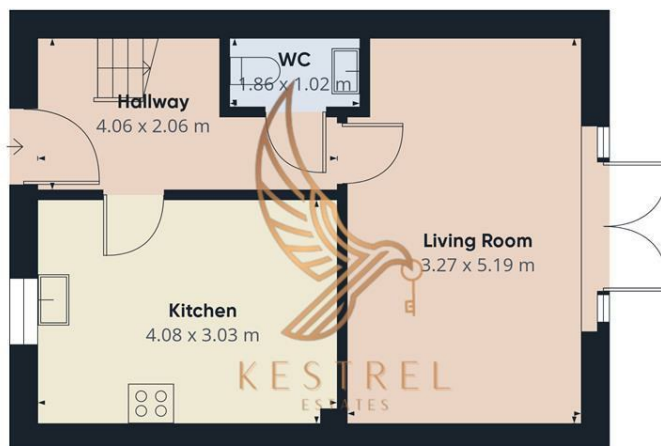

Floor 0

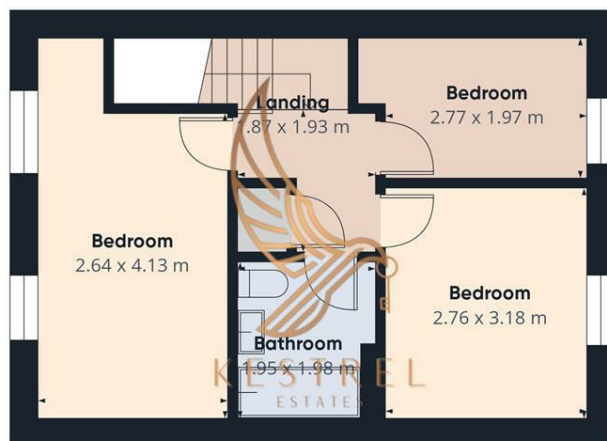

Floor 1



Approximate total area[®]
72.3 m²

Reduced headroom
0.1 m²

(1) Excluding balconies and terraces

Reduced headroom
Below 1.5 m

Calculations reference the RICS IPMS 3C standard. Measurements are approximate and not to scale. This floor plan is intended for illustration only.

GIRAFFE360

